

ECOFLO



Ecoflo transforms the traditional watering can with a thoughtfully designed thumb hole located on the handle. Drawing inspiration from the classic watering bell, the Ecoflo incorporates this innovative airflow feature. By placing your thumb over the hole, you can effortlessly control the water flow, mimicking the function of the watering bell, halting the stream when desired.

While the ability to easily stop the water flow enhances efficiency, the design of the watering bell presents a practical challenge. Without flow control, it often drenches the leaves, which is especially problematic for tropical houseplants, as wet foliage can foster fungal growth. To address this, I adapted the concept into a more precise design, using a traditional spouted watering can, ensuring controlled and targeted watering, ideal for delicate plants.

FEATURES

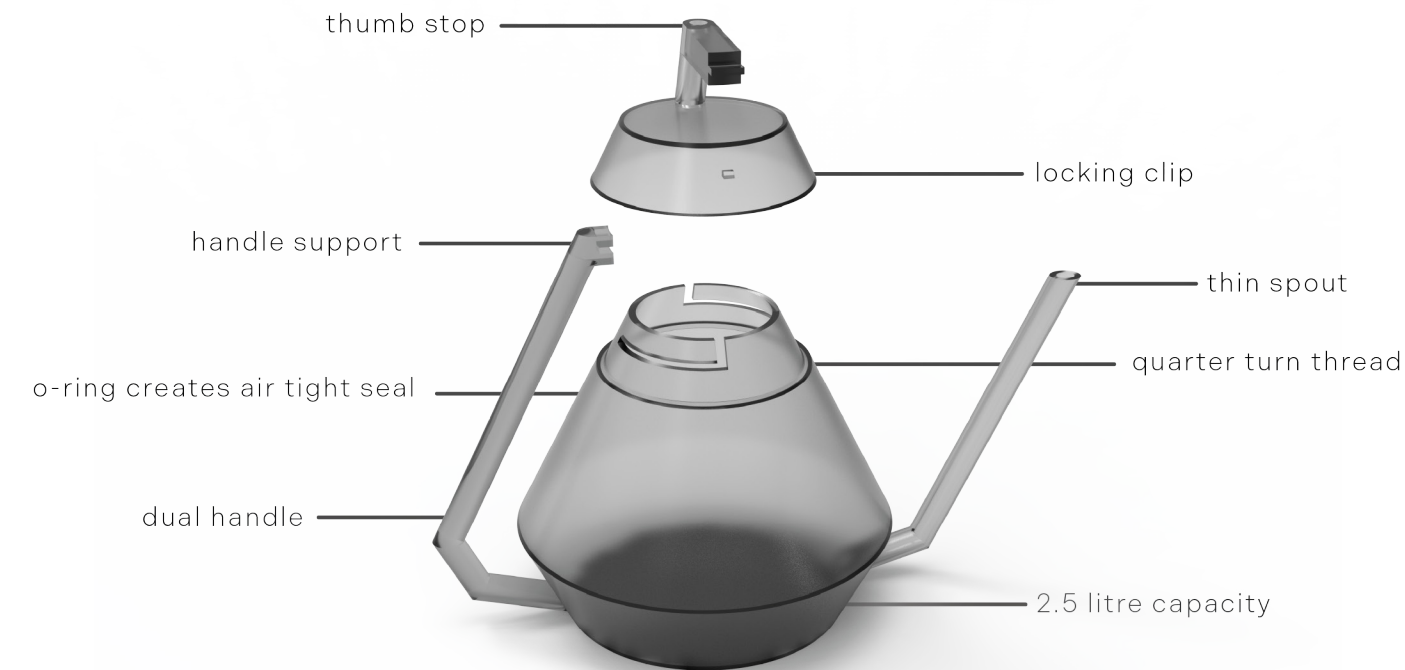

ECOFLO

USE CYCLE

When placing your thumb over the handle's hole, the water stops from pouring out the spout. Due to the pressure difference and surface tension, which act against the force of gravity, the water is pulled back into the watering can.

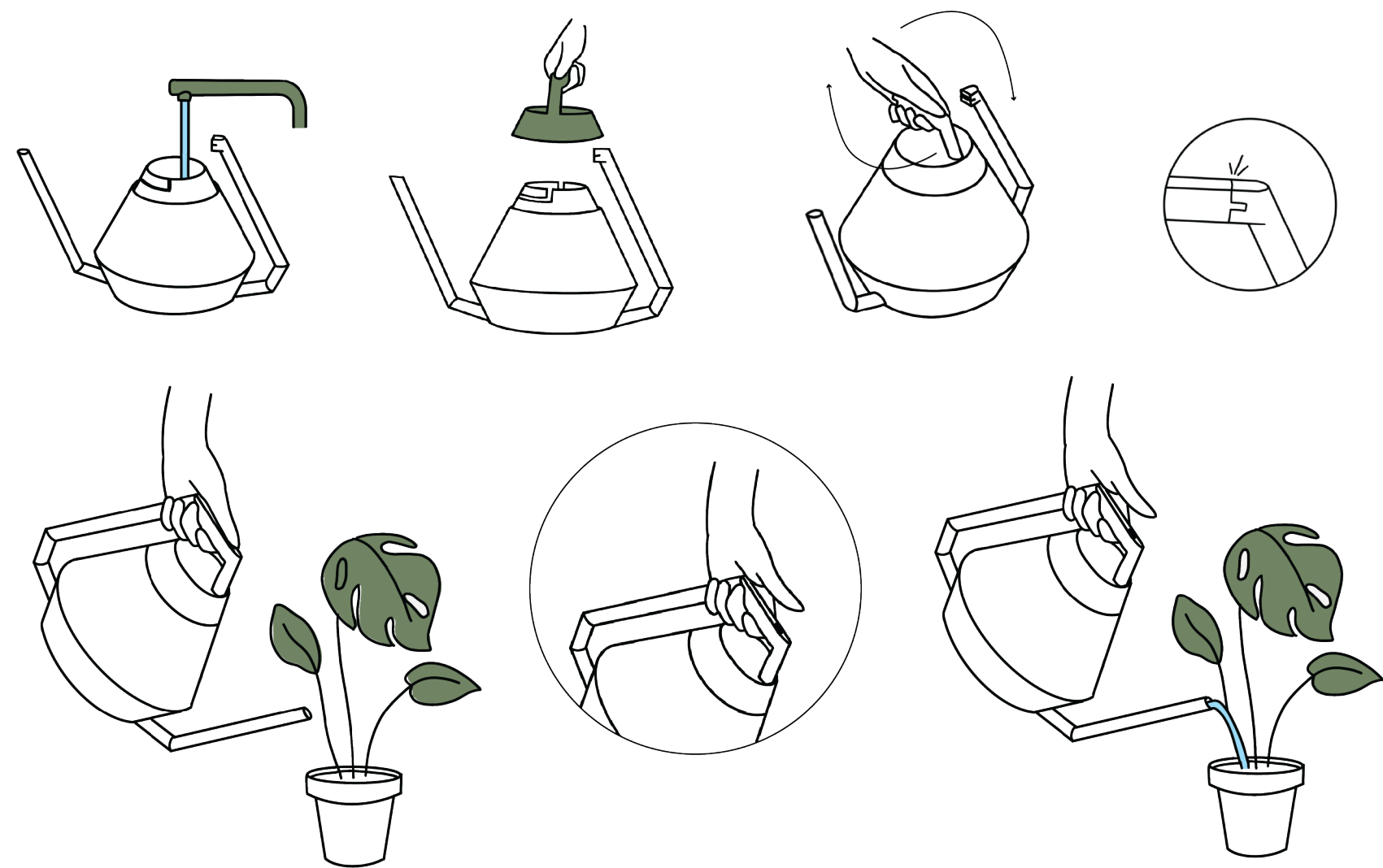

PROCESS

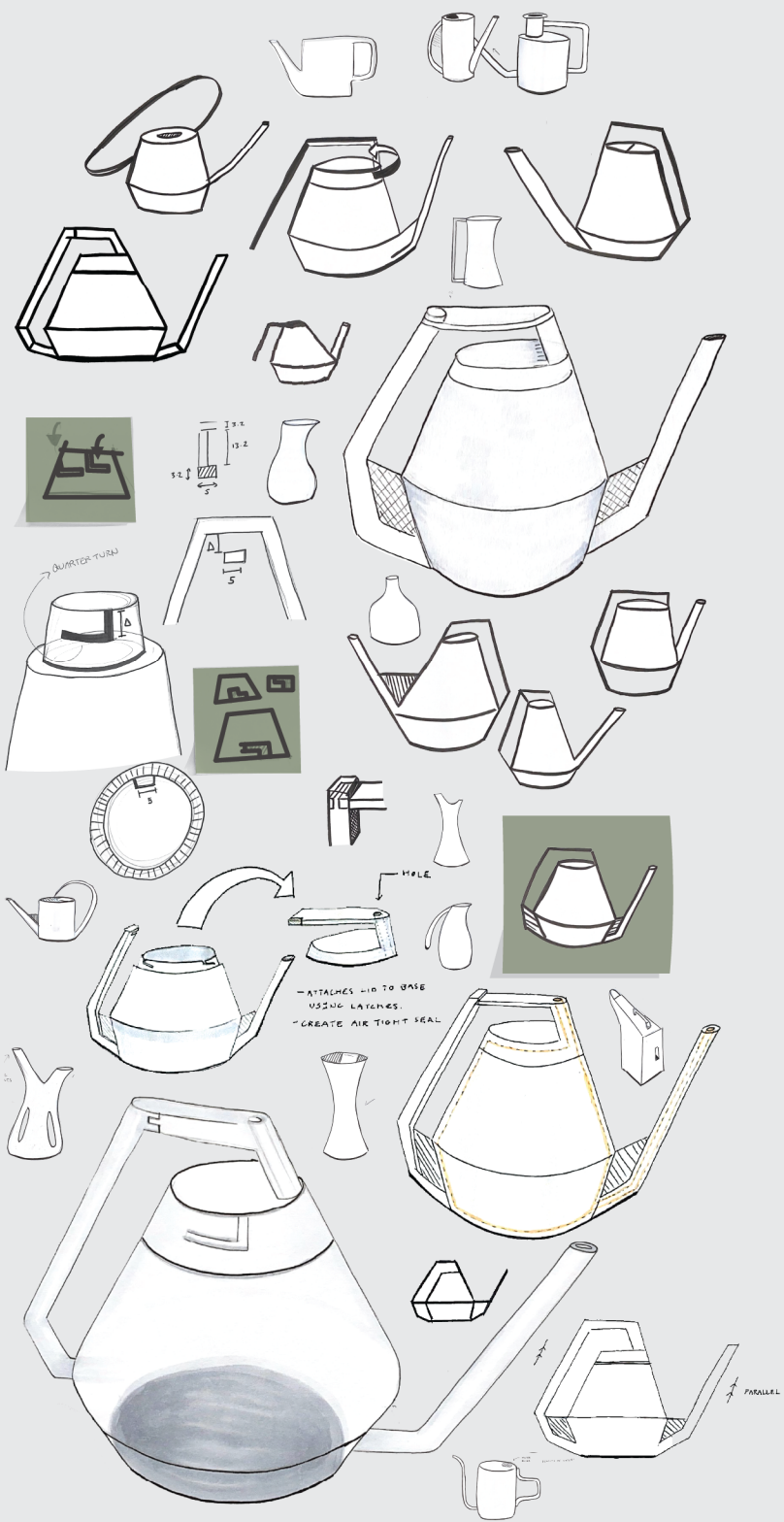

ECOFLO

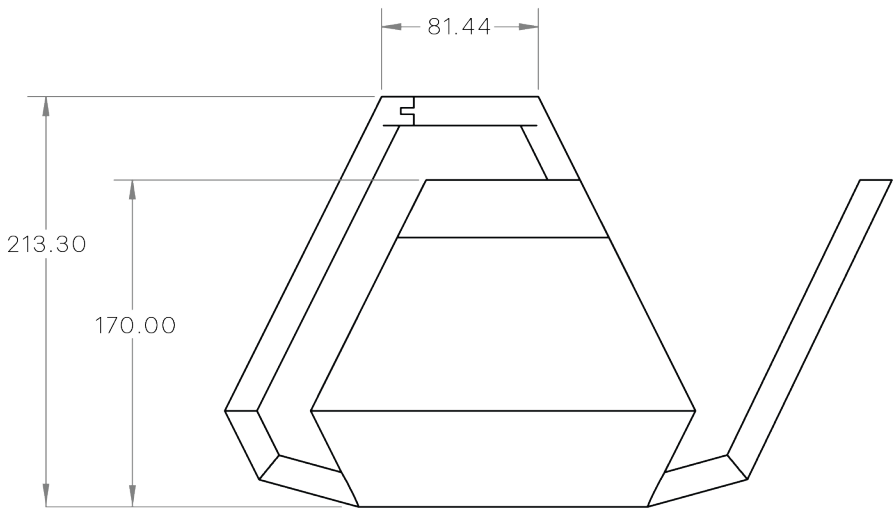
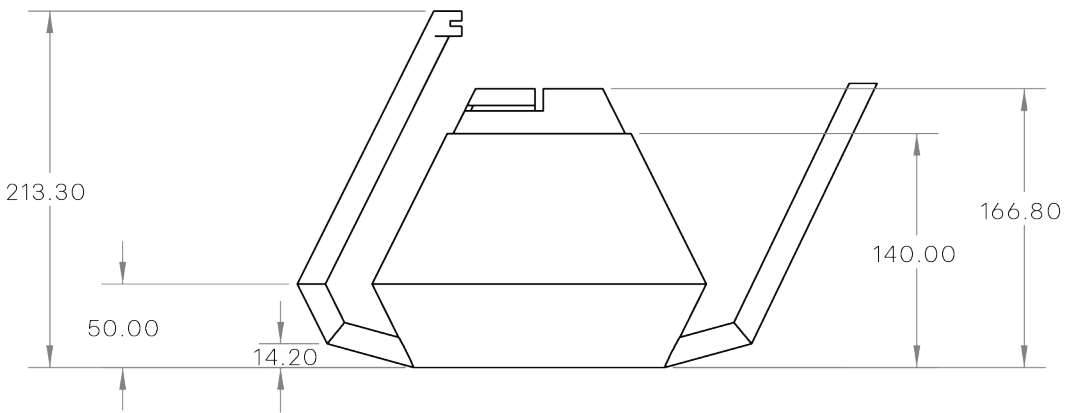
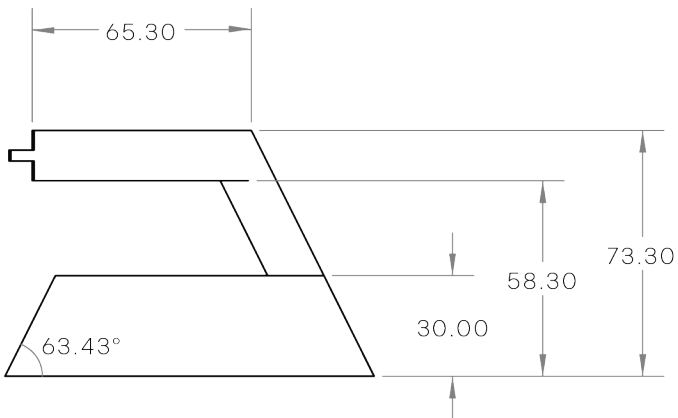

MODEL

A scale model was made to test the size and ergonomics on the products. It is a segmented model made from foam core.



FEATURES

The thin spout gives direct access to soil. The large capacity allows user to water up to 10 plants before needing a refill. Removable lid allows for the airflow hole feature, while still allowing for easy filling capabilities. The rubber ring along the rim of the watering can create a fully air-tight seal.